

ALTERING CASTINGS

Using the cutting techniques described, a number of castings can be modified for further variety:

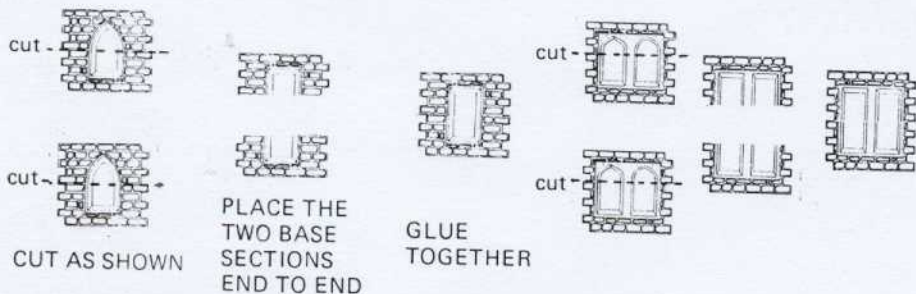

As you grow more skilled at handling Linka castings, many more features can be added to your models:

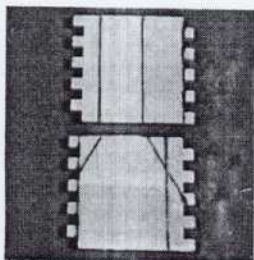

CHIMNEY BREASTS

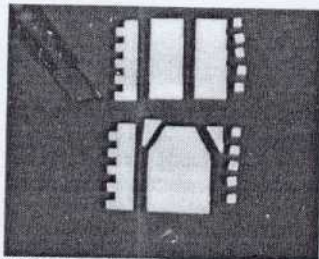

1. MARK OUT SHAPE ON THE REVERSE OF THE CASTINGS.

2. SCORE ALONG THE LINES SEVERAL TIMES THEN SNAP APART.

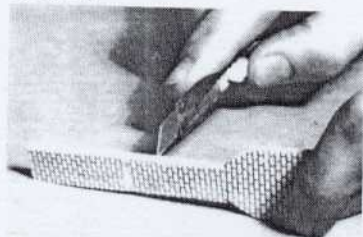
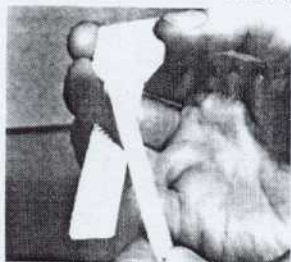

3. GLUE PARTS TOGETHER. WHEN SET, SAND EDGES.

4. ETCH IN MORTAR LINES.

FIX THE COMPLETED ASSEMBLY ON TO THE WALL. If any gaps show between the chimney breast and the wall, fill by painting a weak Linkalite mix into the gaps. (See 'JOINT DISGUISE').

